



API-MO.BRU

VAR-CONTROL CAGE



INSTRUCTIONS FOR USE

1) Insertion of the cage

Put the cage on the foundation on time or insert it on a brood comb that is at the centre of the beehive, cutting the part of comb that is sufficient to contain the small cage without cutting the threads of the framework (see figure). This operation must be done at least a day before the queen is put in the cage, in order to give the bees the possibility to dry honey so that there is a condition of normality when the queen bee is inserted.

Keep the comb always at the centre of the bees colony. This small cage can remain inside the beehive permanently and it can be also used in the swarming period: putting the queen bee in the cage just before the bees breed royal cells and keeping her in this state for ten days or more, the swarming can be reduced.

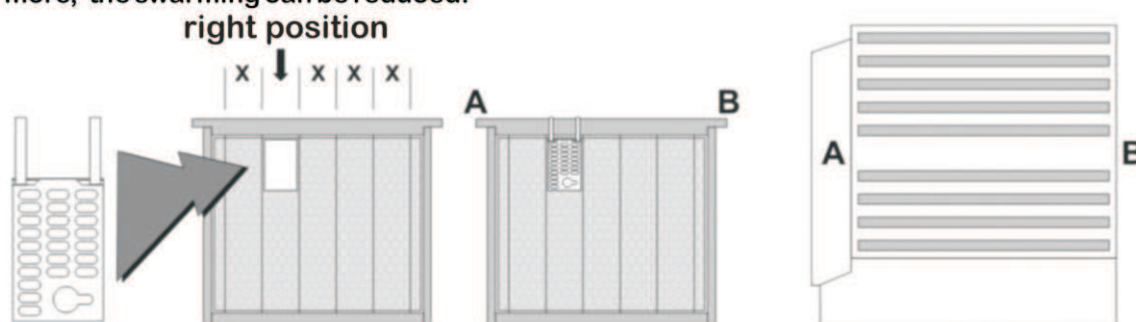

2) Insertion of the queen

When you insert the queen in the small cage you must be careful with smoke, the queen must not be irritated neither before nor after, especially when she is inside the small cage since she has no way out.

To find the queens easier we advise you to mark them before the putting in the cage, in this way you can understand, at the moment of the putting in cage, if the queen has recently been substituted, such a thing is a clear sign that the beehive is in crisis, since there is the varroa, such a thing happens very frequently.

3) Restriction of brood period

To make the putting in the cage at the appropriate moment see "Methods for the putting in cage of the queen for restriction of brood".

To set free the queen bee it is sufficient to open the small door of the small cage and then re-insert the honeycomb to its place.

Attention: do not let the queen bee go out with smoke or other, she will go out spontaneously inside the beehive.

Close the small door after some days to avoid that the bees build inside the small cage. Such a thing happens, if the operation is carried out in spring-summer, on the contrary, if this takes place in autumn, the re-closing of the small door can take place next spring.

Instructions

Be sure that the whole beehive is normal at the moment of the putting in the cage: if in some beehives the queen has been recently replaced (the marked one is not found and there is a young one) be sure that the new queen lays before being put in the cage. It can also happen that the queen is near to the replacement, because she is compromised by a great load of varroa. This can be understood from the presence of royal cells. If this will happen to put in cage the old queen in any case, without damaging the royal cells. After, the bees will choose which is the queen to keep. Finally, before the chemical treatment, if the new queen has laid a little brood, this must be removed. As concerns this, it is useful to remind that from the arrival of varroa, in August/ September the beehives are already compromised, if during the previous year have not been treated well.



API-MO.BRU

OPENING AND CLOSING OF THE SMALL CAGE

- To close the small cage it is sufficient to make a light pressure on the indicated points,

- To open it, one must work on the same points using the levers.

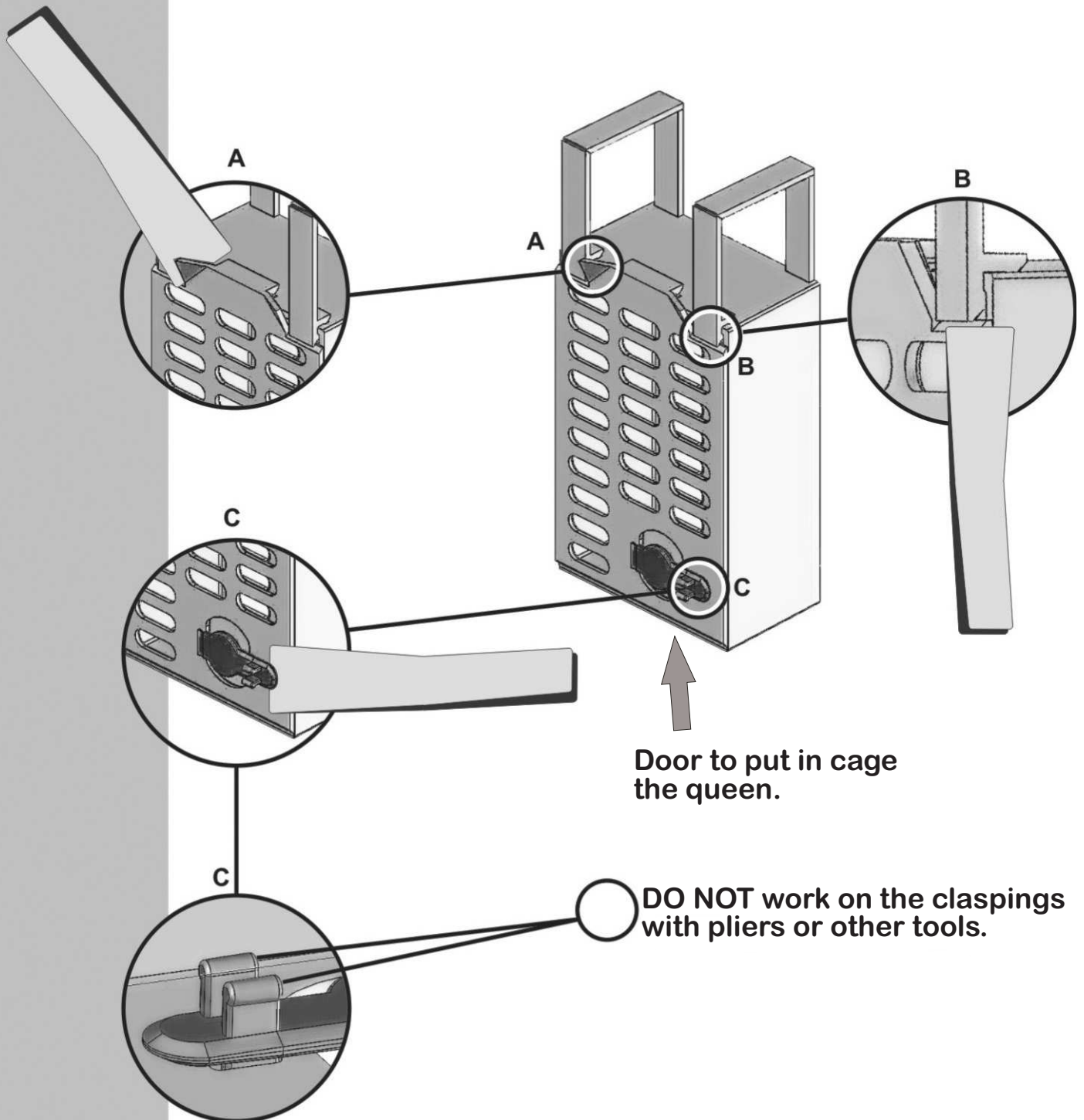

INSERTION OF THE VAR-CONTROL CAGE ON THE FOUNDATION

1) weld the foundation to the frame;

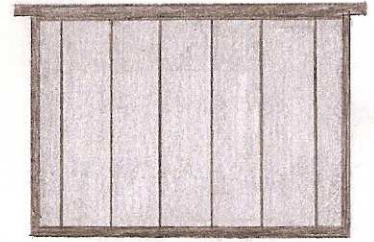

2) supply yourself with a 2 cm thickness and 26 cm x 41 cm dimension plank;

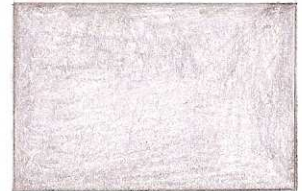

3) lay the frame with the welded foundation over the plank then with a blade knife cut into the rectangle that will contain the cage.

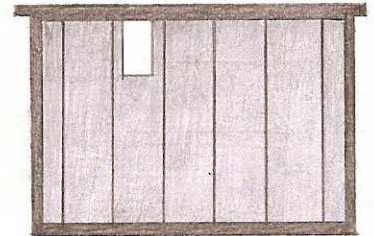

4) It is also useful a 2cm thickness and 5.5 x 9cm dimension plank, that is to be laid over the foundation in order to cut a rectangle.



At the moment of the putting in cage it is better if the beehives have already the cages inserted inside, so that must introduced only the queen to start the restriction of brood. In this way times are speeded up.

It is better if the beekeeper prepares in the laboratory, the foundations or the brood combs built with the cages already inserted and that he introduces them in the beehive in advance.

NOTE: while inserting into the beehive a foundation with the already inserted cage, you must consider that the foundation must be worked by the bees. The right period is Spring/Summer. In the period Summer/Autumn the cage must be inserted on the cage built on the brood comb.